



Proposed Site Layout
1:500

Notes: This drawing is the copyright Paddock Johnson Partnership Limited and may not be used without their prior written consent. Written dimensions to be taken in preference to scaled dimensions. Due to the inaccuracies of scanning, scanned images should not be scaled.

REV:	DATE:	DESCRIPTION:	BY:
A	May 2022	Annotation Amendments	SH
B	29.09.22	Re-design of layout arrangement following LA's feedback	RD
C	27.10.22	Amended proposed site layout following planning officer's comments (21.10.22)	RD
D	22.11.22	Amended proposed site layout following client's comments	RD
E	14.12.22	Annotations amended.	RD
F	27.01.23	Site Layout updated following planning officer's comments	RD
G	07.03.23	Site Layout Annotation updated following Planning Officer's comments	RD
H	13.03.23	Site Layout Re-Arrangement	RD
I	17.03.23	Site Layout Amendments	RD
J	28.03.23	Boundary Line Amendmend following Official Title Plan	RD
K	05.04.23	Annotation Amendments	RD
L	25.04.23	Site Layout updated following planning officer's comments	RD
M	07.06.23	Site Layout updated following planning officer's comments from 31.05.23	RD
N	14.06.23	Updated Site Layout following Planning officer's comments from 13.06.23 - increased amount of visitor parking spaces	RD
O	14.06.23	Parking Layout Re-arranged to suit Planning Officer's Comments	RD
P	04.07.23	Extend OS plan adjacent to Block A, as per Planner's request	HJ

Units Mix:

- 28 no. 1B2P Walk Up Apartments
 - 1 no. 2B3P Bungalow
 - 7 no. 2B4P Houses
 - 5 no. 3B5P Houses
- Total:** 41 units

Parking Arrangement:

- Typical Car Parking Space - 2.5m x 5.0m
- Total:** 68 (14 of which for visitors)

- V** Visitor Spaces
- *** EV Charing Points
12 no. charging points

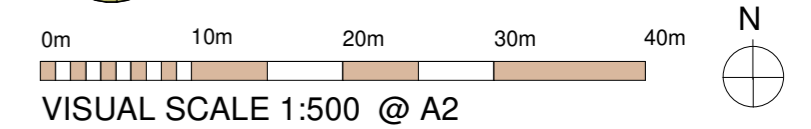
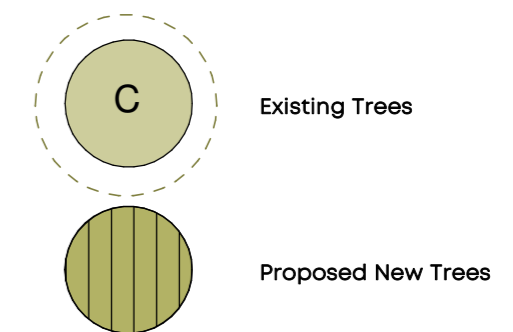

CLIENT:
Shape Land & Property

PROJECT:
New Housing
11-15 Netherfield Lane, Mansfield
NG20 9PA

DRAWING NUMBER:
22042-PJA-00-ZZ-DR-A-1002-P

DRAWING TITLE:
Proposed Site Plan

STATUS:

PLANNING

SCALE: As indicated@A2 DATE: May 2022 BY: RD CHECKED: SH

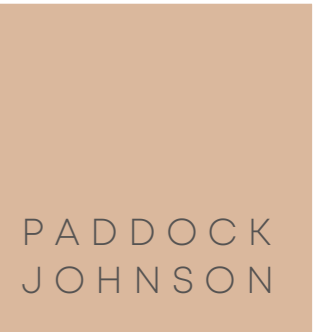

Studio 2, The Lyceum,
Bath Street, Port Sunlight,
Merseyside, CH62 4UJ
0151 643 1234
admin@paddockjohnson.com
www.paddockjohnson.com
Paddock Johnson Partnership
Limited. Registered in England
and Wales. No. 06684275